

GRAND BLEU VINTAGE



MAIN CHARACTERISTICS

- Builder CNB
- Architect Philippe Briand
- Construction material Aluminium
- Category and class MCA + VERITAS: \otimes I 3/3 (E)
YACHT/AL • MACH
- Length overall 28.96 m (95')
- Beam 7.00 m (23')
- Draft 3.60 m (11'8)
- Light displacement 80 t (176,000 p)
- Mast height 34.50 m (113')
- Main engine CUMMINS 6 CTA 350 HP **372 h**
- Sail Area 410 m² (4413 sq. ft)
- Fuel capacity 2 x 2,000 l (2 x 528 gal)
- Water capacity 3,500 l (925 gal)
- Water ballast 3,500 l (925 gal)

ASKING PRICE: 2,300,000 € VAT NOT PAID

Location: Antibes - France

Year built / refit: 2003 / 2013 - 2020



Grand Bleu Vintage built in 2003 is an elegant and unique sailing yacht.

Built by CNB in Bordeaux, designed by the famous architect Philippe Briand, she has had only two owners, the current one since 2005. The boat has been exceptionally well maintained by her two successive captains, with two refits (in 2013 and 2021). She is classified MCA + VERTITAS: I 3/3 (E) Yacht/AL: MACH

Grand Bleu Vintage is fast and responsive at the helm and stiff thanks to the 3.5 t ballast. A true pleasure sailboat, as efficient on long ocean crossings as during the Voiles de Saint-Tropez, Antigua Race Week, or the St. Barth Bucket!

At sea or at anchor, the central cockpit, designed for "living on deck", becomes the preferred space to enjoy the pleasures of sailing or lazing around. This cockpit is rivaled only by the saloon, where, well protected from the sun and wind, comfortably installed behind the "mirror" windows, passengers enjoy the 180° view.

Leather, maple, mahogany, Alcantara, with its sober but refined decoration, "Grand Bleu Vintage" is fitted out for eight passengers. The crew quarters are close to the technical area, very comfortable and separate, with two cabins, a lounge and the kitchen.

The large dinghy is located below the aft deck with direct access to the sea. The self-tacking cutter rig and shallow draft for this large sailboat simplify maneuvering and accessibility to the anchorage.

Grand Bleu Vintage is elegant, ready to take to the sea to go to the end of the world in complete tranquility...

MAIN CHARACTERISTICS

- Builder CNB
- Architect Philippe Briand
- Construction material Aluminium
- Category and class MCA + VERITAS: I 3/3 (E) ✕ YACHT/AL • MACH
- Length overall 28.96 m (95')
- Length waterline 25.14 m (82'48)
- Beam 7.00 m (23')
- Draft 3.60 m (11'8)
- Ballast 27 t (59,500 p)
- Light displacement 80 t (176,000 p)
- Mast height 34.50 m (113')
- Sail Area 410 m² (4413 sq. ft)
- Fuel capacity 2 x 2,000 l (2 x 528 gal)
- Water capacity 3,500 l (925 gal)
- Water ballast 3,500 l (925 gal)

MAIN EQUIPMENT

- Main engine CUMMINS 6 CTA 8.3M3 350 HP TURBO **372 h**
- Propeller Max Prop 3 blades (auto-feathering)
- Steering system Chain/cable + Autopilot
- Bow thruster MAX POWER 30 Hp
- Water maker SEA RECOVERY 200 l/h (52 gal/h) **370 h**
- Spars Carbon fibre 4 spreaders
Canoe boom with "easy reefing"
- Standing rigging NAVTEC rod discontinuous
NAVTEC hydraulic rams & pump
- Running rigging GLEINSTEIN Spectra/Vectran/Tergal
- Genoa furler RECKMAN hydraulic
- Stay sail furler RECKMAN hydraulic
- Deck hardware HARKEN 3 manual winches
HARKEN 8 hydraulic winches
HARKEN hardware
- Anchoring LOFRANS Hercule electric windlass
120 m of 16 mm chain (390', 5/8)
1 CQR anchor 81 Kg (176 lb.)
1 Bruce anchor 30 Kg (66 lb.)
- Safety Comply with MCA & VERITAS
- Generators ONAN 1 X 17,5 kW 220V 50 Hz **2602 h**
1 X 30 kW 220V 50 Hz **3368 h**
- Engine room ventilation G&R 3.400 m³/h
- Air conditioning MARINE AIR 93.000 BTU 220V 50/60Hz

- | | | |
|------------------------|---------------|-----------------------|
| • Batteries | SONNENSCHNEIN | 24V 1500 A/h |
| • Battery charger | MASTERVOLT | 3x100 A/h |
| • Toilets | TECMA | Silent line, electric |
| • Wastewater treatment | HAMANN | Super Mini |

Galley equipment

- | | | |
|-------------------|-----------|----------------------------|
| • Stove | MIELE | Induction |
| • Oven | BOSCH | Electric |
| • Range hood | | 900 m3/h (32,000 cu. ft/h) |
| • Micro-wave oven | BOSCH | |
| • Laundry washer | CANDY 4KG | 900 |
| • Dryer | BOSH | Série 4 |
| • Dish washer | COMENDA | BHC433, 3 min/cycle |
| • Refrigerator | FRIGOMAR | 500 l (130 gal) |
| • Freezer | FRIGOMAR | 450 l (118 gal) |
| • Hot water | PACIFIC | 150 l (40 gal) |

Accommodations

- Guest:
- Main salon/dining area for 6/8 persons
- 1 owner cabin with ensuite bathroom (fwd)
- 3 double guest cabins with ensuite bathrooms

- Crew:
- 1 aft skipper's cabin with double bed
- 1 bathroom
- 1 double-bunk aft crew cabin
- 1 Navigation station
- Galley starboard

Deck

- Teak deck
- Central cockpit with low table starboard with built-in fridge
- 2 "Le Corbusier" hydraulic sofas
- Foldable dining table on the port side
- Sunbathing area with cushions
- Aft hydraulic platform
- Aft helm cockpit
- Tender garage under aft deck
- Hydraulic crane to launch the tender
- Aft swim-platform

Sails - Awnings

- Spectra mainsail, 1,680 sq. ft (2021)
- Spectra staysail, 1,120 sq. ft (2020)
- Spectra 120% Genoa, 2,300 sq. ft (2020)
- Dacron storm jib, 538 sq. ft (2003)
- Asymmetric spinnaker Airx 900, 5,540 sq. ft (2003)
- Spinnaker sock

- Main companion way dodger 2018
- Central cockpit foldable Bimini 2018
- Awning 2018

Paint

- AWLGRIP process FLAG BLUE

1.1 Electronics

- Radar Furuno 24m colour
- 4 VHF mobile ICOM ICM 25
- 1 active echo
- 1 NAVTEX NX-700 FURUNO
- 1 PLOTTER RL 80 C RAYMARINE
- 1 BAROMETER MÉTÉO LINER VÉTUS
- 1 FLEET ONE
- 1 IMMARSAT C SAILOR 6006
- 1 SMOKE DETECTOR D109 MARINELEC
- 1 SYNOPTIC NAVIGATION LIGHTS MARINELEC
- 2 GPS - GP 32 FURUNO. Et GP 39 FURUNO
- 5 B&G Graphic display
- 2 B&G analogue display TWS 0-50 KT
- 2 B&G analogue display MAG AWA
- 2 B&G analogue display TWA 360
- 2 Sailmon E Ink display
- Pack autopilot NAC3 with compass precision 9
- Autopilot control panel type Simrad AP48

Computer

- PC HP Prodisk
- CD- DVD driver
- Windows 10

- Time Zero navigation software (Ex Maxsea)
- Flat screen TFT18",1
- Printer HP 640 C
- UPS 700

Safety equipment

- 3 Zodiac ZMEC 6 pax life rafts
- 3 HAMMAR H20 hydrostatic release for life rafts
- Zodiac CFR 340 with 15Hp Yamaha HE rescues boat
- 14 life jacket adult + 2 Child
- EPIRB
- SAILOR SART
- GMDSS Handheld VHF SIMRAD AXIS 50

Entertainment

Each cabin with CD/Radio stereo PIONEER with 2 speakers

Saloon:

- 1 plasma screen 42' LG
- 1 home-cinema DVD et CD

Miscellaneous

- Semi rigid tender with 40 HP YAMAHA in aft garage
- Zodiac FAST ROLLER MK II with 15HP YAMAHA outboard engine as an MCA rescue boat

LAFOURCADE YACHT BROKER is acting as broker for the vendor who is not selling in the course of business unless otherwise stated. These details are prepared from information provided by the vendor and are intended only as a guide to give a fair description of the vessel, but their accuracy cannot be guaranteed, and they do not constitute part of any contract. A prospective buyer is strongly advised to check the particulars and to have the vessel fully surveyed by a qualified marine surveyor. Details are supplied on the understanding that all negotiations shall be through LAFOURCADE YACHT BROKER. This vessel is offered subject to prior sale, price change or withdrawal without notice.

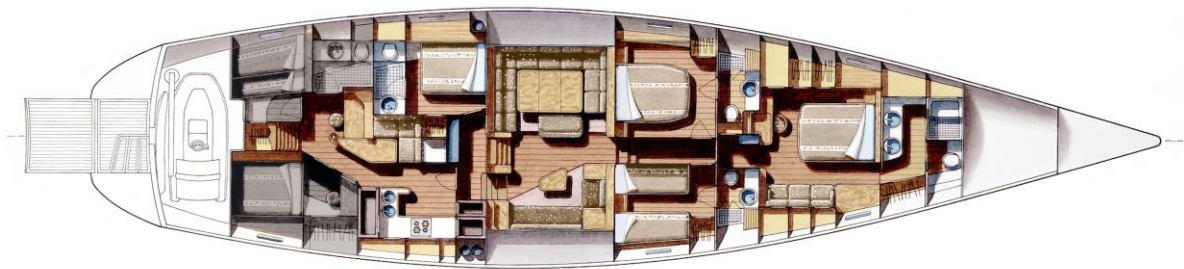



Grand Bleu Vintage - Photo Nicolas clairs



Grand Bleu Vintage - Photo Nicolas clairs

LAFOURCADE/YACHT BROKER

+33 680 593 873 – o.lafourcade@yachtbroker.fr



Grand Bleu Vintage - Photo Nicolas Joris



Grand Bleu Vintage - Photo Nicolas Joris

LAFOURCADE/YACHT BROKER

+33 680 593 873 – o.lafourcade@yachtbroker.fr



Grand Bleu Vintage - Photo Nicolas clairs



Grand Bleu Vintage - Photo Nicolas clairs

LAFOURCADE/YACHT BROKER

+33 680 593 873 – o.lafourcade@yachtbroker.fr



Grand Bleu Vintage - Photo Nicolas clairs



Grand Bleu Vintage - Photo Nicolas clairs

LAFOURCADE/YACHT BROKER

+33 680 593 873 – o.lafourcade@yachtbroker.fr



Grand Bleu Vintage - Photo Nicolas elans



Grand Bleu Vintage - Photo Nicolas elans

LAFOURCADE/YACHT BROKER

+33 680 593 873 – o.lafourcade@yachtbroker.fr



Grand Bleu Vintage - Photo Nicolas clairs



Grand Bleu Vintage - Photo Nicolas clairs

LAFOURCADE/YACHT BROKER

+33 680 593 873 – o.lafourcade@yachtbroker.fr



LAFOURCADE/YACHT BROKER

+33 680 593 873 – o.lafourcade@yachtbroker.fr



LAFOURCADE/YACHT BROKER

+33 680 593 873 – o.lafourcade@yachtbroker.fr



Grand Bleu Vintage - Photo Nicolas Claris



Grand Bleu Vintage - Photo Nicolas Claris

LAFOURCADE/YACHT BROKER

+33 680 593 873 – o.lafourcade@yachtbroker.fr



LAFOURCADE/YACHT BROKER

+33 680 593 873 – o.lafourcade@yachtbroker.fr



Grand Bleu Vintage - Photo Nicolas Cluets



Grand Bleu Vintage - Photo Nicolas Cluets

LAFOURCADE/YACHT BROKER

+33 680 593 873 – o.lafourcade@yachtbroker.fr



Grand Bleu Vintage - Photo Nicolas claris



Grand Bleu Vintage - Photo Nicolas claris

LAFOURCADE/YACHT BROKER

+33 680 593 873 – o.lafourcade@yachtbroker.fr



CNB - Grand Bleu Vintage - Photo Nicolas Claris



Grand Bleu Vintage - Photo Nicolas Claris

LAFOURCADE/YACHT BROKER

+33 680 593 873 – o.lafourcade@yachtbroker.fr



Grand Bleu Vintage - Photo Nicolas Claris



Grand Bleu Vintage - Photo Nicolas Claris

LAFOURCADE/YACHT BROKER

+33 680 593 873 – o.lafourcade@yachtbroker.fr



Grand Bleu Vintage - Photo Nicolas clairs



Grand Bleu Vintage - Photo Nicolas clairs

LAFOURCADE/YACHT BROKER

+33 680 593 873 – o.lafourcade@yachtbroker.fr



Grand Bleu Vintage - Photo Nicolas claris



CNB - Grand Bleu Vintage - Photo Nicolas Claris

LAFURCADE/YACHT BROKER

+33 680 593 873 – o.lafourcade@yachtbroker.fr



CNB - Grand Bleu Vintage - Photo Nicolas Claris

LAFOURCADE/YACHT BROKER

+33 680 593 873 – o.lafourcade@yachtbroker.fr

GRAND BLEU VINTAGE
 Polar Diagram
 100% loaded
 Windward ballast tank full

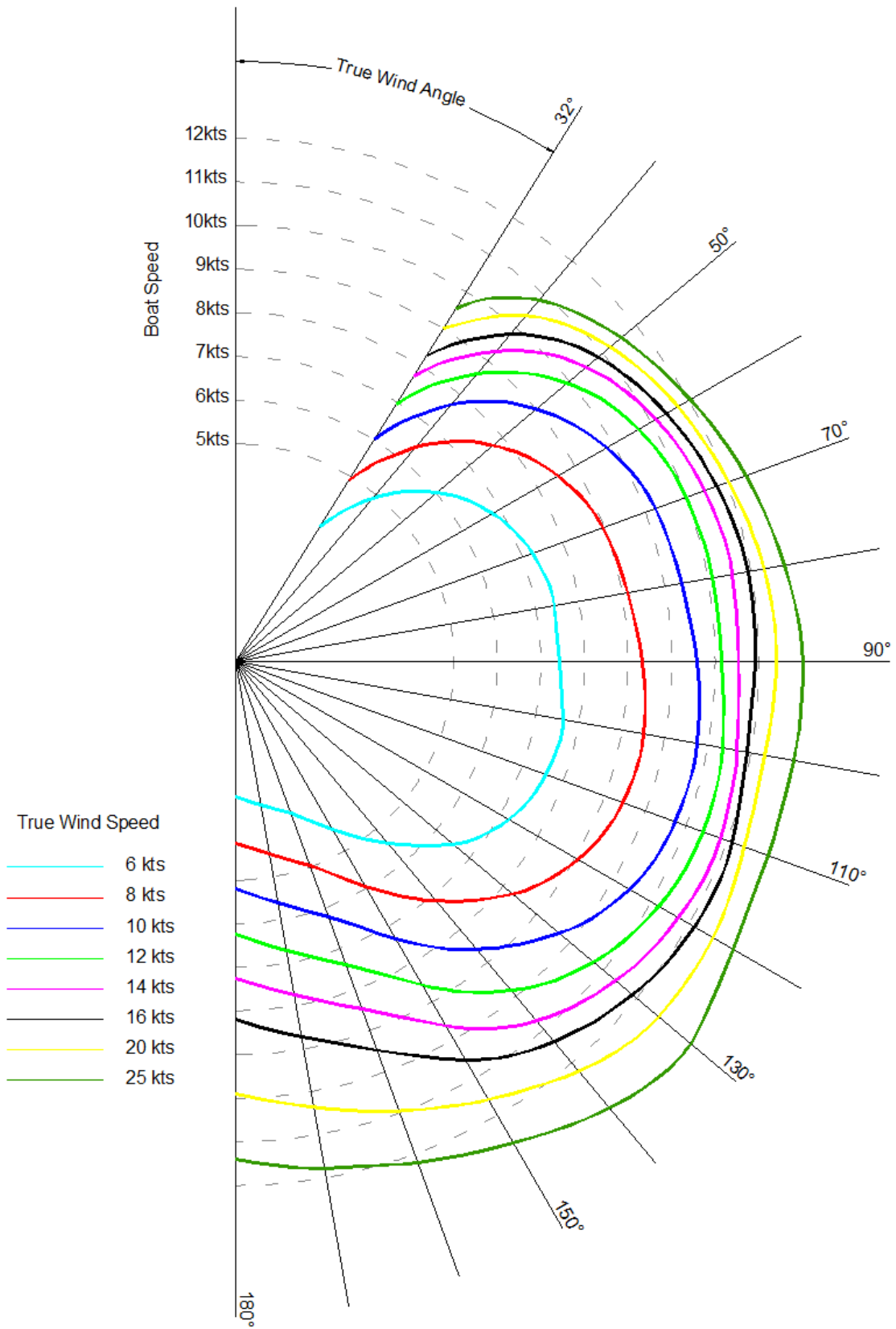

PHILIPPE BRIAND DESIGN

LAFOURCADE/YACHT BROKER

+33 680 593 873 – o.lafourcade@yachtbroker.fr